

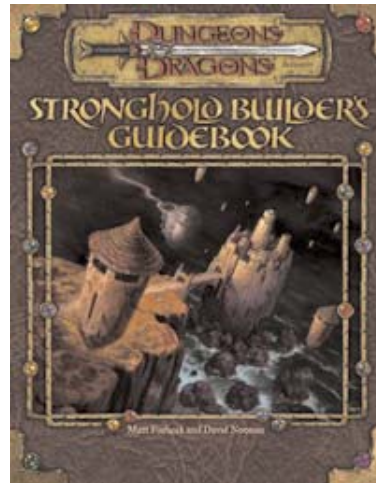

CONSTRUCTION JOURNAL: THE ALQALINDE GUILDHOUSE

A Stronghold Builder's Guidebook
Web Enhancement by David Noonan



The *Stronghold Builder's Guidebook* is comprehensive resource detailing everything a Dungeon Master or player needs to design, construct, and play with castles, fortresses, towers, and more. As an example of how to build a stronghold within the context of an ongoing campaign—and as a reasonably priced fortress for your own character's use—here's the Alqalinde Guildhouse. This is a tower created by Oriel, a 13th-level wizard in a campaign we've got going in the Wizards of the Coast Roleplaying R&D department.

To use this web enhancement, you must already have the *Stronghold Builder's Guidebook*—you will need to refer to it as you read along. You also will want to refer to the maps of the completed Guildhouse featured on pages 4 to 6 of this document.

This bonus game material is exclusive to the official DUNGEONS & DRAGONS® website: www.wizards.com/dnd.

GETTING STARTED

Oriel, tired of a local noble's hegemony over the arcane arts, has decided to found his own guild called Alqalinde, which means “secret-sharers” in Elven. But to attract apprentices (and eventually more powerful allies), he needs to build a guildhouse. Fortunately, recent forays against the yuan-ti and the giants have been lucrative, so Oriel and his allies have 150,000 gp to spend to get the Alqalinde guild off the ground. Oriel figures he can probably afford something castle sized, so he tries to design a structure with about 20 stronghold spaces.

When Oriel begins construction, he knows he wants to build a tower in the center of the capital city of Forghul, and that part of the tower will be underground. Forghul is a large city (price modifier of +6%), and the climate/ terrain is temperate plains (price modifier of –5%).

Now comes the fun part: buying components. Oriel doesn't have to worry much about defense, because his magic will provide that, and the center of the capital city is pretty safe.

Accordingly, Oriel purchases all the components listed on the table on the following page:

Additional Credits

Editing and Typesetting: Sue Weinlein Cook
Cartography: Sean K Reynolds
Web Production: Julia Martin
Web Development: Mark Jindra
Graphic Design: Sean Glenn, Cynthia Fliege

Based on the original DUNGEONS & DRAGONS® game by E. Gary Gygax and Dave Arneson and on the new edition of the DUNGEONS & DRAGONS game designed by Jonathan Tweet, Monte Cook, Skip Williams, Rich Baker, and Peter Adkison.

D&D, DUNGEONS & DRAGONS, and DUNGEON MASTER are registered trademarks and the d20 System logo is a trademark owned by Wizards of the Coast, Inc. All Wizards characters, character names, and the distinctive likenesses thereof are trademarks owned by Wizards of the Coast, Inc.

This material is protected under the copyright laws of the United States of America. Any reproduction or unauthorized use of the material or artwork contained herein is prohibited without the express written permission of Wizards of the Coast, Inc.

This product is a work of fiction. Any similarity to actual people, organizations, places, or events is purely coincidental.

This Wizards of the Coast game product contains no Open Game Content. No portion of this work may be reproduced in any form without written permission.

To learn more about the Open Gaming License and the d20 System License, please visit www.wizards.com/d20.

©2002 Wizards of the Coast, Inc.

All rights reserved.

Made in the U.S.A.

Visit our website at

www.wizards.com/dnd



WALLS AND TOWERS

The Alqalinde Guildhouse is 21 stronghold spaces. Ordinarily, this means half the walls are interior, and half are exterior. But Oriel wants the same kind of wall for both interiors and exteriors, so the math should be simpler.

Oriel opts for hewn stone interior and exterior interior walls. The underground walls are free, so 7.5 stronghold spaces have no wall cost. The other 13.5 stronghold spaces cost 6,000 gp per space, or 81,000 gp.

That's too expensive, but fortunately Oriel is a 13th-level wizard who knows *wall of stone*. This gives him a 50% discount, and the walls cost only 40,500 gp. Looking as some of the other do-it-yourself spellcasting discounts, Oriel sees that *fabricate* gives him a 5% discount on regular spaces and a 20% discount on fancy spaces. *Stone shape* gets a further 5% discount on spaces with hewn stone walls—which is all of them. Those discounts are worth a total of 6,510 gp.

But Oriel is vain enough to want the Alqalinde Guildhouse to stand out in the Forghul skyline. So he puts two stronghold spaces 30 feet high, two spaces 40 feet high, and so on up to 70 feet high. That means an additional 21,800 gp. But again Oriel's ability as a spellcaster comes to the rescue. Together, *telekinesis* and *fly* cut the height surcharge by 75%, so the towering edifice costs only 5,450 gp. (Oriel is going to be spending a lot of time on-site, casting spells to help the builders.)

OTHER EXTRAS

Oriel wants a secret passageway between his bedroom and the fancy magic lab, so that means buying two secret doors (Search DC 30) at 400 gp. He upgrades each exterior bedroom door to strong wood (400 gp), buys an iron portcullis for the gatehouse (750 gp), and buys stone doors for both magic labs (he doesn't want anything escaping) and the meeting room (privacy is a virtue). Five stone doors cost 1,500 gp. Each upgraded door gets a good lock (Open Lock DC 30), which adds an additional 450 gp. Finally, every aboveground stronghold space gets iron bars and glass on its windows (1,050 gp). And the meeting hall, fancy magic laboratory, and Oriel's bedroom suite and study get lead-lined walls (6,400 gp), which block *detect* spells. Oriel is tired of being spied upon.

Item	Spaces	Cost
Wizard's Research Cluster (underground)	5.5	17,200 gp
Deluxe Alchemical Lab		
Fancy Library		
Fancy Magic Lab		
Fancy Office		
Servants' Quarters		
Basic Privy		
Magic Laboratory, Basic (underground)	1	500 gp
Office, Basic	.5	200 gp
Gatehouse	1	2000 gp
Hall, Dining	2	2000 gp
Office, basic	.5	200 gp
Armory	1	500 gp
Kitchen, Extended	1	2,500 gp
Bedrooms, Common	1	700 gp
Tavern, Fancy	1	4000 gp
Basic Privy	.5	300 gp
Bedrooms, Common	2	1400 gp
Office, Fancy	1	2,500 gp
Bedrooms, Common	1	700 gp
Bedroom Suite, Fancy	1	5,000 gp
Barracks (underground)	1	400 gp

MAKING SENSE OF THE LIST

When you build a stronghold, it's often easiest to first look at the clusters: collections of components that work well together. Oriel also notes which components go underground, because they'll have different wall costs (which he'll pay for later).

For the Alqalinde Guildhouse, the Wizard's Research Cluster is an obvious choice. The masters get to use the fancy laboratory, of course, and Oriel decides on a second, more basic magic lab for the apprentices. They'll live in a barracks—after all, they're apprentices.

There are 10 basic bedrooms (remember, each bedroom component has two bedrooms) for guildmasters and Oriel's fellow adventurers when they're in town. The dining hall and extended kitchen are enough to support the bedroom guests, the apprentices in the barracks, and the servants.

Oriel adds a fancy bedroom suite and fancy office for himself, and a meeting chamber (paid for as if it were a fancy tavern) for the guild leaders. A gatehouse makes a nice entrance, and Oriel's fellow adventurers insist he add an armory for accumulated loot. Finally, he adds two basic offices, one for the castellan and one for the guards.

WONDROUS ARCHITECTURE

The fancy magic laboratory has an engraved *magic circle against evil* (1,500 gp) for *planar binding* spells and the like. The security-conscious Oriel also pays for *inscriptions of vacancy* on the meeting hall (22,500 gp) and *inscriptions of privacy* in his bedroom suite (14,000 gp). His office gets a *pool of scrying* (7,500 gp), and the gatehouse gets a *warding bell* (7,200 gp). Oriel could build these items, as he could any magic item, but he's loath to spend the experience points, so he'll just buy them.

A few weeks ago, Oriel had some trouble with teleporting assassins, but he can't afford enough *forbidding sigils* (see sidebar) to protect the entire stronghold. Maybe he'll get the party's cleric to cast *forbiddance* on the Alqalinde Guildhouse when construction is complete.

RUN THE TOTALS

Oriel has made all his construction choices, and his plans for the Alqalinde Guildhouse are complete. The total cost is 146,642 gp, just slightly under budget. It'll take 15 weeks to build the guildhouse, and with the amount of spellcasting required of Oriel, he'll have to be there much of the time. Time to talk with the other players and the DM about taking the winter off from defending the realm.

MAKING IT LOOK GOOD

Now that Oriel knows the details for his stronghold, it's time to map it. Originally, Oriel tried a traditional tower, with crenellations, staircases, and all the medieval trappings. But no matter how gothic he makes the Alqalinde Guildhouse, it blends into the cityscape. Oriel isn't evil, but he does have a sinister streak, so he designs a building that looks like an abode of the powerful.

Oriel imagines a double helix of rooms centered around a huge granite spike and connected by tunnels that run through the otherwise solid spike. All the rooms hang off the edge of the granite spike like mushrooms on a tree trunk.

Planning the interior corridors, Oriel varies from a strict double helix, because he wants certain connections (such as the guildmaster's study and bedroom

suite) to be easy. Constructing a fortress based on a double helix turns out to be a strong choice from a security standpoint. Oriel puts all the public areas on one helix, and more private areas on the other. For example, one helix starts at the gatehouse and ascends through the dining hall, past the kitchen and the castellan's office, to the meeting room and the bedrooms beyond. The other helix heads from guard captain's office to the armory, then there's a break. When the second helix reemerges, it connects the meeting room to the guildmaster's study and bedroom suite.

Guildmaster Oriel can privately travel among his office, bedroom, meeting room, and magic laboratory (the latter through a secret tube that runs down the center of the granite spike—it's omitted from the map for clarity). Mundane guests never need to travel beyond the dining room, and more trusted guests can easily access the meeting room and kitchen. And Oriel is strange enough to like the subtly disorienting effect of tube-hallways of solid, smooth granite that get ever steeper as you ascend through the guildhouse.

When he'd done, Oriel smiles to himself. His rivals won't be able to ignore him anymore...

New Wondrous Architecture *Forbidding Sigils*

These inscriptions guard a stronghold space from unwanted visitors—extraplanar or otherwise. A *sigil* has two effects: First, the area is sealed from extradimensional travel into it, including *dimension door*, *teleport*, *plane shift*, and *summoning* spells. Second, creatures with alignments different from the caster's cannot enter the area. Creatures whose alignments differ in one aspect (lawful evil vs. chaotic evil, for example), suffer 3d6 points of damage and are hedged out. Creatures whose alignments differ in two aspects (chaotic good vs. lawful neutral) suffer 6d6 points of damage.

A successful Will save (DC 19) negates both effects, but if a character fails the save once, future attempts automatically fail.

Dispel magic automatically fails against *forbidding sigils* unless the dispeller is 11th level or higher.

Caster Level: 11th; *Prerequisites:* Craft Wondrous Item, *forbiddance*; *Market Price:* 12,200 gp.

See the results for yourself on the Guildhouse maps starting on the next page.

Alqalinde Guildhouse (side view)

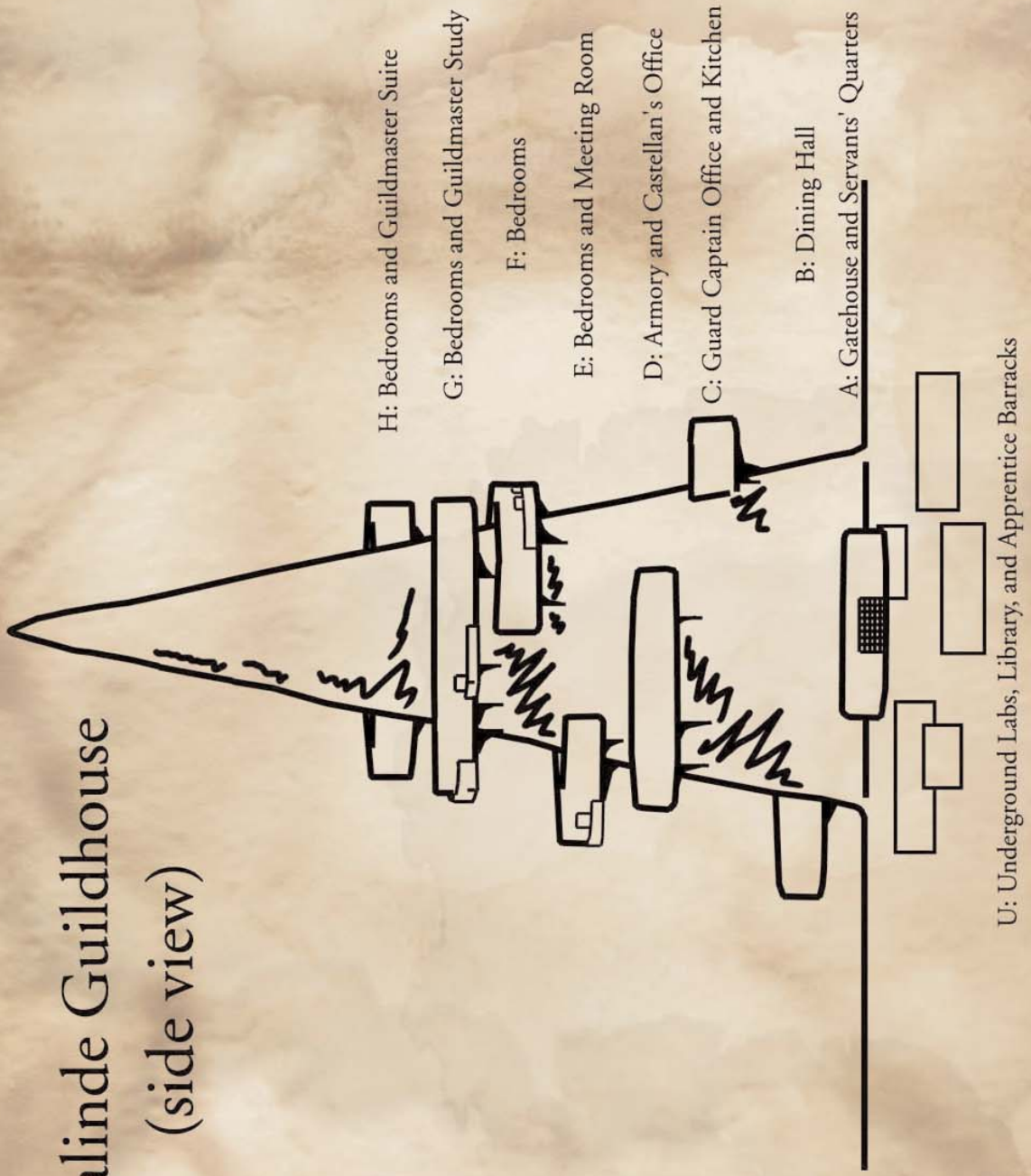



□ = 5 feet

A: Ground Level

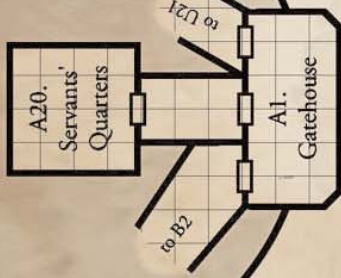

The Alqalinde Guildhouse

B: 10 Foot Elevation

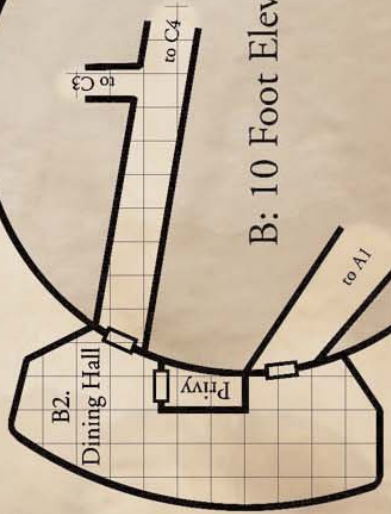

U: Underground

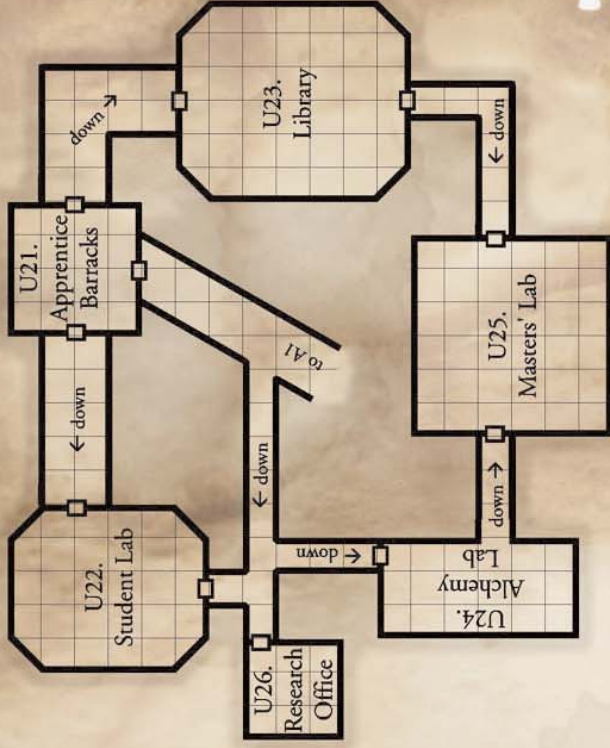

C: 20 Foot Elevation

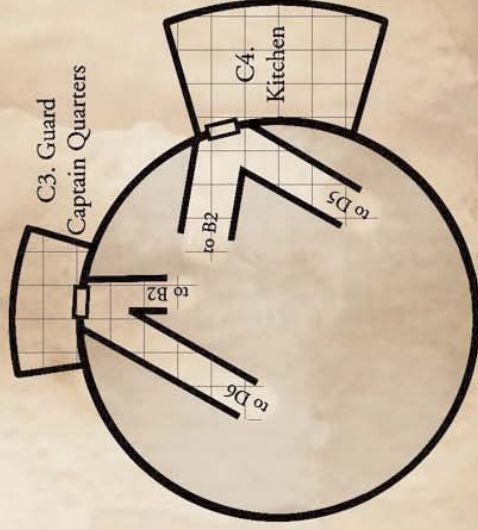

D: 30 Foot Elevation

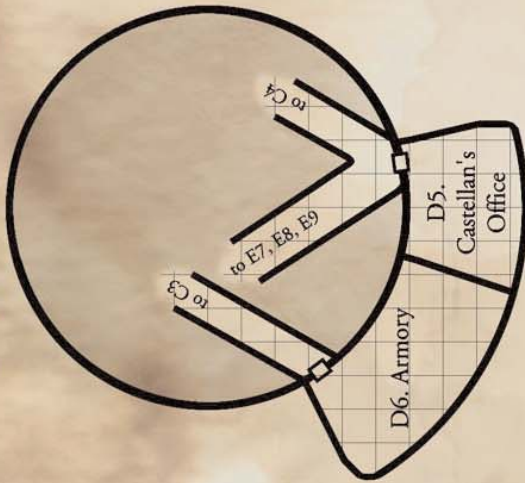

□ = 5 feet

E: 30 Foot Elevation

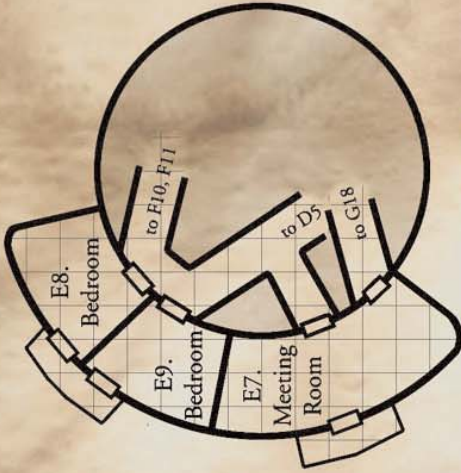

G: 60 Foot Elevation

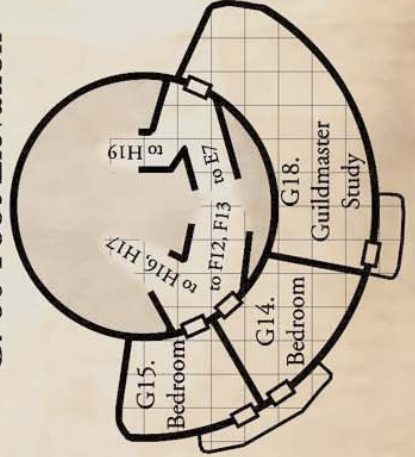

H: 70 Foot Elevation

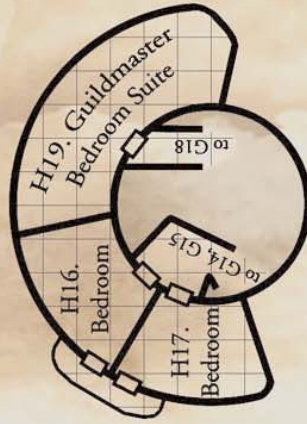

F: 50 Foot Elevation

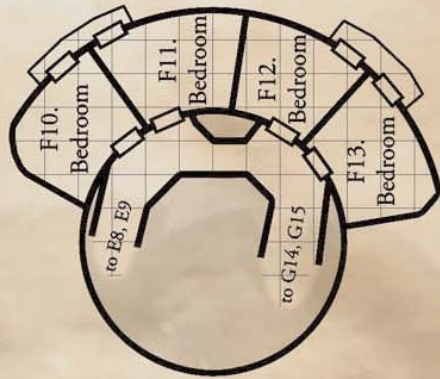



ABOUT THE AUTHOR

David Noonan is a designer and editor for the Core DUNGEONS & DRAGONS team at Wizards of the Coast. His credits include codesigning and editing the *D&D Adventure Game* and parts of the new *Player's Handbook*, *DUNGEON MASTER's Guide*, and *MONSTER MANUAL*®. He's also the coauthor of the *Hero Builder's Guidebook*, *Sword and Fist*, *Song and Silence*, and the *Stronghold Builder's Guidebook*. His wife lets him out once a year, so please excuse his wild-eyed, frantic behavior.

ABOUT THE CARTOGRAPHER

Sean K Reynolds was born in a coastal town in southern California. A professional game designer since 1998, he coauthored the *FORGOTTEN REALMS*® *Campaign Setting* and the *Living GREYHAWK*® *Gazetteer* for the new edition of DUNGEONS & DRAGONS, as well as many other books. After leaving a design position at Wizards of the Coast, he spends his free time reading and creating computer animation—and now maps. Read more about him at <www.seankreynolds.com>.